

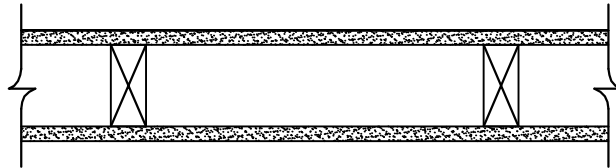

# **W3 1 HOUR FIRE ASSEMBLY - WOOD FRAMED WALL** **w/ 5/8" GYPSUM BOARD**

Typical Frame Wall Assembly 5/8" unrated Gypsum Wall Board attached to 2 x 4 southern yellow pine studs at 16" o.c. with 1-5/8" course thread dry wall screws spread per local building code



**TO ACHIEVE 1 HOUR FIRE RATING:**

**APPLY 10 MIL THICKNESS (DRY) OF ForceField® FireGuard® E-84 TO EXPOSED SIDE OF GYPSUM BOARD**

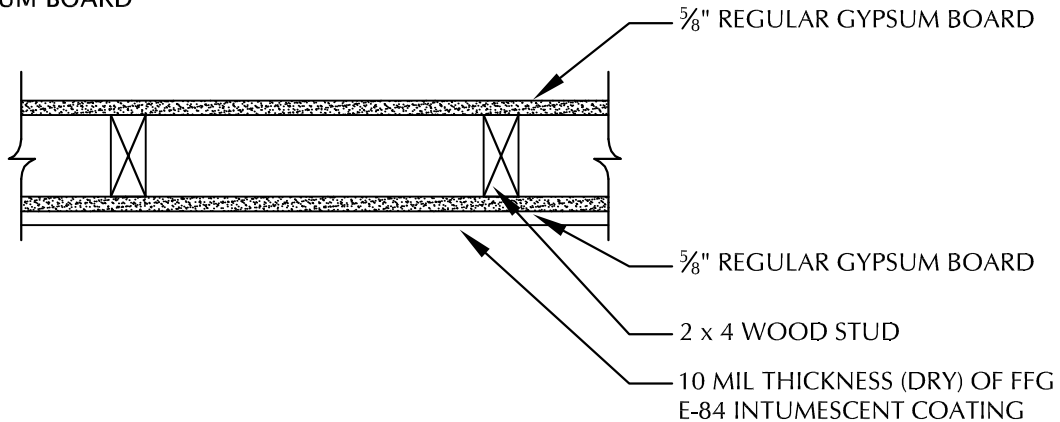

**SCALE: N.T.S.**

<b>FIRE TEST ENDURANCE RATING:</b>	<b>1 HOUR</b>
<b>STANDARD TESTED TO:</b>	<b>ASTM E-119-10b</b>
<b>FIRE TESTED LABORATORY:</b>	<b>GUARDIAN FIRE TESTING LABORATORIES, INC. 480 HINMAN AVE. BUFFALO, NY 14216</b>
<b>REPORT NO:</b>	<b>GL 61011</b>
<b>PRODUCT:</b>	<b>ForceField® FireGuard® E-84 INTUMESCENT COATING (FFG E-84)</b>
<b>MANUFACTURER:</b>	<b>SHIELD INDUSTRIES, INC. 131 SMOKEHILL LANE WOODSTOCK, GA 30188</b>

**\* SEE MANUFACTURER APPLICATION INSTRUCTIONS AND SPECIFICATIONS FOR SURFACE PREPARATION AND APPLICATION PROCESS**