

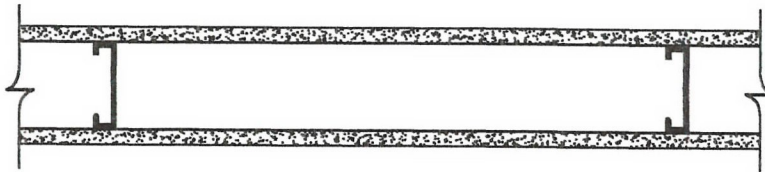

# Shield Industries, Inc.

## S3 1 HOUR FIRE ASSEMBLY - STEEL FRAMED WALL w/ 5/8" GYPSUM BOARD

Typical Frame Wall Assembly 5/8" unrated and "X" rated Gypsum Wall Board attached to 3-5/8" steel studs at 24" o.c. with 1" Type S drywall screws 8" o.c. spread per local building code



TO ACHIEVE 1 HOUR FIRE RATING:

APPLY 10 MIL THICKNESS (DRY) OF ForceField® FireGuard® E-84 TO EXPOSED SIDE OF GYPSUM BOARD

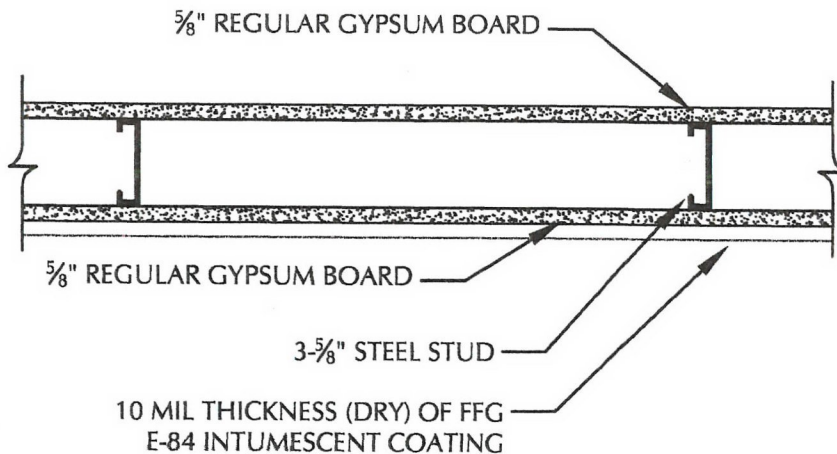

SCALE: N.T.S.

FIRE TEST ENDURANCE RATING:	1 HOUR
STANDARD TESTED TO:	ASTM E-119-10b
FIRE TESTED LABORATORY:	GUARDIAN FIRE TESTING LABORATORIES, INC. 480 HINMAN AVE. BUFFALO, NY 14216
REPORT NO:	GL 61011
PRODUCT:	ForceField® FireGuard® E-84 INTUMESCENT COATING (FFG E-84)
MANUFACTURER:	SHIELD INDUSTRIES, INC. 131 SMOKEHILL LANE WOODSTOCK, GA 30188

\* SEE MANUFACTURER APPLICATION INSTRUCTIONS AND SPECIFICATIONS FOR SURFACE PREPARATION AND APPLICATION PROCESS



*R. Joseph Pearson*  
11/27/13



*Laura Ann Hinton* 11/18/13