

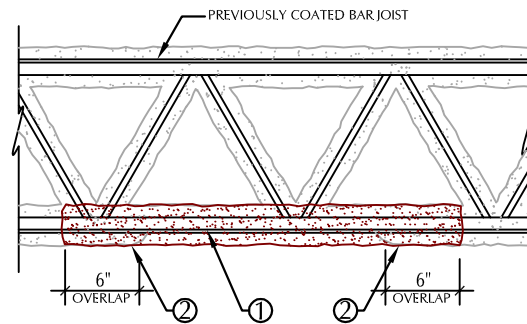

P-1

STEEL DECK BEAMS AND COLUMNS PREVIOUSLY COATED WITH CEMENTITIOUS FIRE PROOFING

STEEL DECK BEAMS AND COLUMNS AS WELL AS STEEL PREVIOUSLY
COATED WITH CEMENTITIOUS FIRE PROOFING (SFRM)

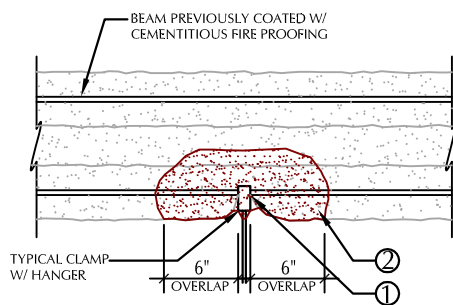

TO ACHIEVE 1, 1 ½, & 2 HOUR FIRE RATING:

Apply required mils (dry) of Forcefield® Fireguard® E-84 to face of all exposed steel members w/ damaged fireproofing. Damaged steel area must be cleaned appropriately and specified steel primer applied if needed. The SFRM that will be overlapped and receive the application of Forcefield® Fireguard® E-84 must be dry and free of dirt, loose debris and oily contaminants that would affect adhesion of Forcefield® Fireguard® E-84. The overlap should be 6 inches or more.

	DURATION		
	1 HOUR	1 ½ HOUR	2 HOUR
STRUCTURAL STEEL USED AS A COLUMN	REQUIRED DRY MIL THICKNESS		
LIGHT WEIGHT (0-10 LBS/LFT)	60 MIL	N/A	N/A
MEDIUM WEIGHT (10-25 LBS/LFT)	40 MIL	60 MIL	60 MIL
HEAVY WEIGHT (25 > LBS/LFT)	35 MIL	60 MIL	60 MIL
STRUCTURAL STEEL USED AS A BEAM	REQUIRED DRY MIL THICKNESS		
LIGHT WEIGHT (0-10 LBS/LFT)	60 MIL	60 MIL	N/A
MEDIUM WEIGHT (10-25 LBS/LFT)	30 MIL	60 MIL	60 MILS
HEAVY WEIGHT (25 > LBS/LFT)	30 MIL	60 MIL	60 MILS

① DAMAGED AREA OF STEEL TO BE CLEAN, FREE OF DIRT, GRIME AND OIL. APPLY ALKYD STEEL PRIMER IF NEEDED PRIOR TO APPLICATION OF FIREGUARD E-84

② TO ACHIEVE DESIRED RATING - APPLY REQUIRED MILS (DRY) THICKNESS FFG-84 INTUMESCENT COATING AT DAMAGED AREAS PROVIDING 6" OVERLAP (SEE ADJACENT CHART FOR REQUIRED MILS)

SCALE: N.T.S.

FIRE TEST ENDURANCE RATING:	1 HOUR, 1 1/2 HOUR, 2 HOUR
STANDARD TESTED TO:	ASTM E-119
FIRE TESTED LABORATORY:	GUARDIAN FIRE TESTING LABORATORIES, INC. 480 HINMAN AVE. BUFFALO, NY 14216
REPORT NO:	GL88311-A, GL58812, GL115611 & EER 77812
PRODUCT:	ForceField® FireGuard® E-84 INTUMESCENT COATING (FFG E-84)
MANUFACTURER:	SHIELD INDUSTRIES, INC. 131 SMOKEHILL LANE WOODSTOCK, GA 30188

* SEE MANUFACTURER APPLICATION INSTRUCTIONS AND SPECIFICATIONS FOR SURFACE PREPARATION AND APPLICATION PROCESS