



FW6

1 HOUR FIRE ASSEMBLY - WOOD FLOOR

TYPICAL FLOOR ASSEMBLY: FLOORING: $\frac{7}{8}$ " X $\frac{3}{4}$ " T&G

SUBFLOOR: $3\frac{5}{8}$ " X $\frac{5}{4}$ " SPLINE DECKING

BEAMS: $11\frac{5}{8}$ " X $13\frac{5}{8}$ ", 14" X 17"

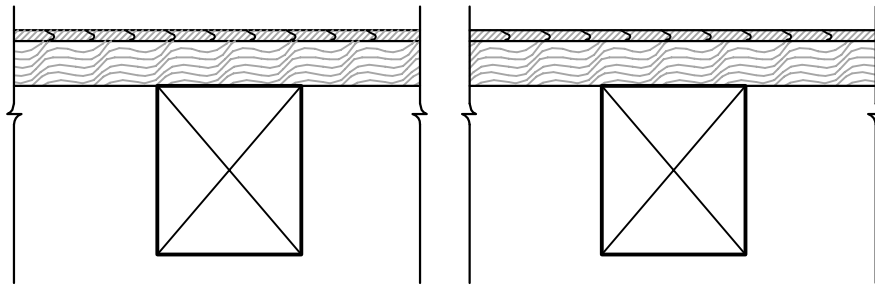

TO ACHIEVE 1 HOUR FIRE RATING:

Apply 30 mil thickness (dry) of Forcefield® Fireguard® E-84 to the deck.

Apply 10 mil thickness (dry) of Forcefield® Fireguard® E-84 to beams.

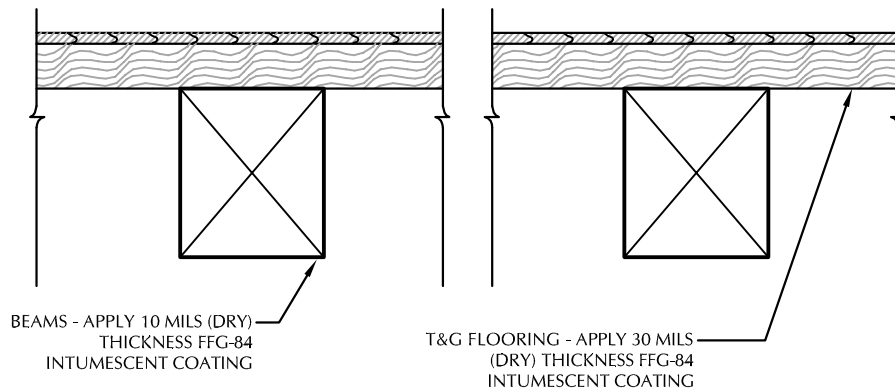

SCALE: N.T.S.

FIRE TEST ENDURANCE RATING:	1 HOUR
STANDARD TESTED TO:	ASTM E-119
FIRE TESTED LABORATORY:	GUARDIAN FIRE TESTING LABORATORIES, INC. 480 HINMAN AVE. BUFFALO, NY 14216
REPORT NO:	GL 115411
PRODUCT:	ForceField® FireGuard® E-84 INTUMESCENT COATING (FFG E-84)
MANUFACTURER:	SHIELD INDUSTRIES, INC. 131 SMOKEHILL LANE WOODSTOCK, GA 30188

* SEE MANUFACTURER APPLICATION INSTRUCTIONS AND SPECIFICATIONS FOR SURFACE PREPARATION AND APPLICATION PROCESS