

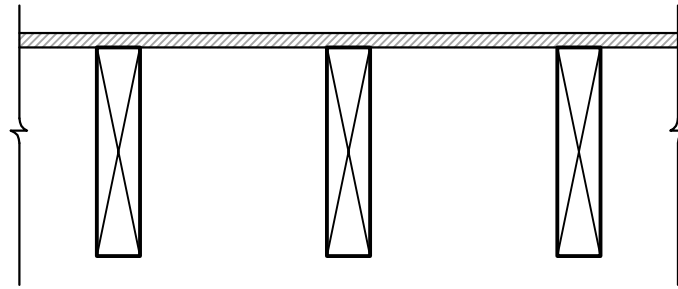

**FW4**

## 1 HOUR FIRE ASSEMBLY - WOOD FLOOR

TYPICAL FLOOR ASSEMBLY: FLOORING: 1" X 4" T&G PLANK SHEATHING  
JOIST: 3" X 14½"



### TO ACHIEVE 1 HOUR FIRE RATING:

Apply 30 mil thickness (dry) of Forcefield® Fireguard® E-84 to the following areas:

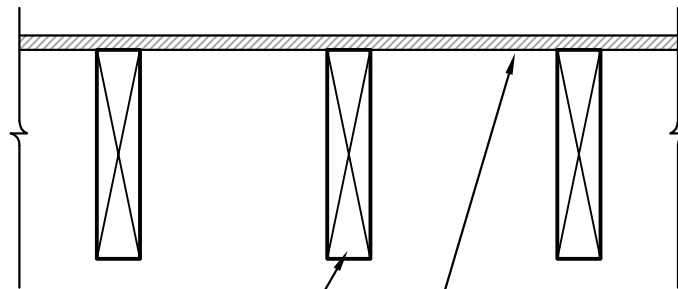

JOIST - APPLY 30 MILS (DRY)  
THICKNESS FFG-84  
INTUMESCENT COATING

1" X 4" T&G FLOORING - APPLY  
30 MILS (DRY) THICKNESS  
FFG-84 INTUMESCENT COATING

SCALE: N.T.S.

<b>FIRE TEST ENDURANCE RATING:</b>	<b>1 HOUR</b>
<b>STANDARD TESTED TO:</b>	ASTM E-119
<b>FIRE TESTED LABORATORY:</b>	GUARDIAN FIRE TESTING LABORATORIES, INC. 480 HINMAN AVE. BUFFALO, NY 14216
<b>REPORT NO:</b>	GL 115411
<b>PRODUCT:</b>	ForceField® FireGuard® E-84 INTUMESCENT COATING (FFG E-84)
<b>MANUFACTURER:</b>	SHIELD INDUSTRIES, INC. 131 SMOKEHILL LANE WOODSTOCK, GA 30188

\* SEE MANUFACTURER APPLICATION INSTRUCTIONS AND SPECIFICATIONS FOR SURFACE PREPARATION AND APPLICATION PROCESS