

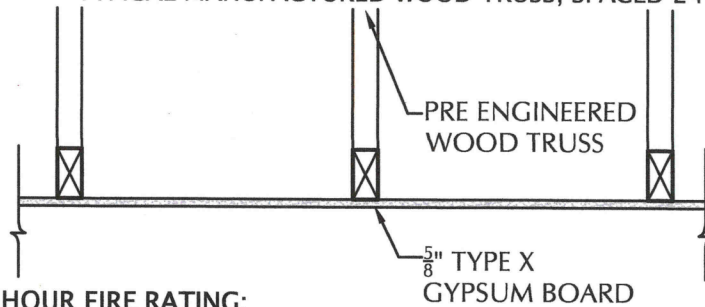

FC-7

1 HOUR FIRE ASSEMBLY - WOOD TRUSS / GYPSUM CEILING

$\frac{5}{8}$ " TYPE X GYPSUM BOARD APPLIED TO THE BOTTOM CHORD
TYPICAL MANUFACTURED WOOD TRUSS, SPACED 24" O.C.



TO ACHIEVE 1 HOUR FIRE RATING:

Apply 30 mil thickness (dry) of Forcefield® Fireguard® E-84 to face of $\frac{5}{8}$ " gypsum type x wallboard. (NO "or equal" allowed)

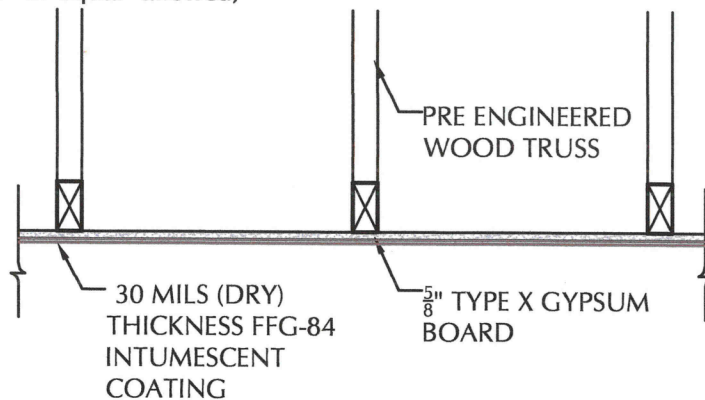

SCALE: N.T.S.

FIRE TEST ENDURANCE RATING:	1 HOUR
STANDARD TESTED TO:	ASTM E-119 - 10a, NFPA 251, UL 263, SMALL SCALE TEST, CAN/UL-S-101-07 WITH NO LOAD CAPACITY
FIRE TESTED LABORATORY:	GUARDIAN FIRE TESTING LABORATORIES, INC. 480 HINMAN AVE. BUFFALO, NY 14216
REPORT NO:	GL 60911 & EER 81612
PRODUCT:	ForceField® FireGuard® E-84 INTUMESCENT COATING (FFG E-84)
MANUFACTURER:	SHIELD INDUSTRIES, INC. 131 SMOKEHILL LANE WOODSTOCK, GA 30188
* SEE MANUFACTURER APPLICATION INSTRUCTIONS AND SPECIFICATIONS FOR SURFACE PREPARATION AND APPLICATION PROCESS	