

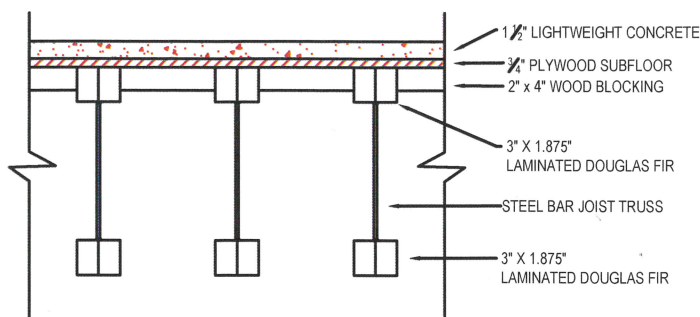

FC-6

1 Hour Floor Ceiling Assembly: Existing 32" wood and steel bar joist truss with top and bottom cords constructed from 3" x 1.875" laminated Douglas Fir. 2"x4" wood blocking, one layer of 0.75" plywood and 1.5" of light weight concrete.

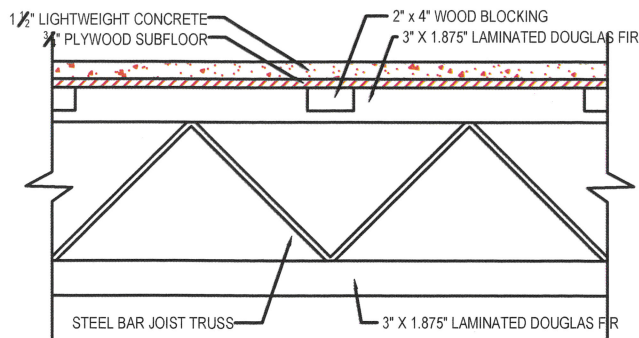

To achieve 1 hour fire rating for the above floor ceiling assembly:

Apply 30 ml dry thickness of FireGuard E-84® Intumescent Coating to all exposed plywood decking and 45 ml dry thickness of FireGuard E-84® Intumescent Coating to all exposed wood blocking and exposed steel bar joist truss.

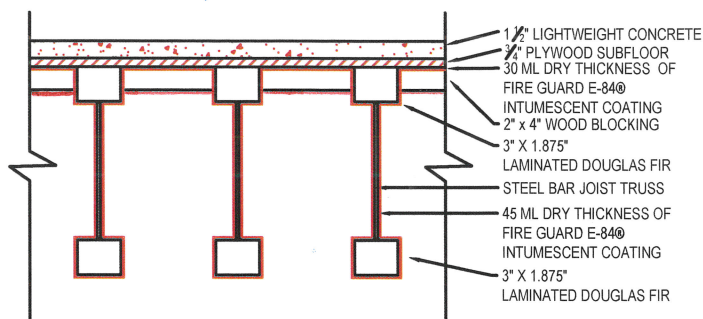
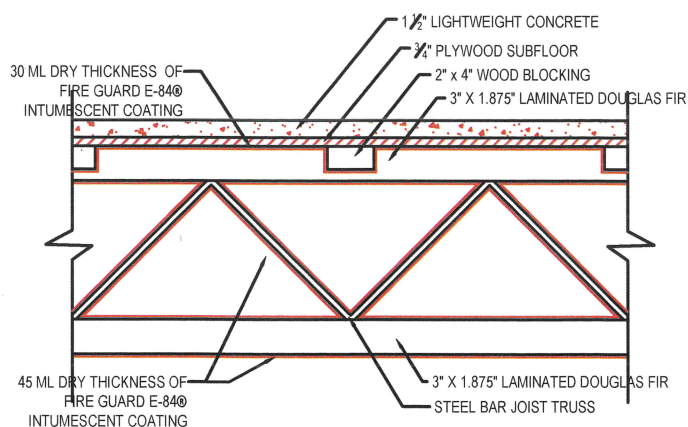

FIRST TEST ENDURANCE RATING:	1 HOUR
STANDARD TESTED TO:	ASTM E-119-10B, UL 263. NFPA 251. ULC-S-1 Building Construction and Materials
FIRE TESTED LABORATORY:	GUARDIAN FIRE TESTING LABORATORIES, INC. 480 Hinman Ave. Buffalo, NY 14216
REPORT TO:	GL 58812 Rev & GL 115411, EER-38193
PRODUCT:	FireGuard E-84® Intumescent Coating
MANUFACTURER:	SHIELD INDUSTRIES, INC. 131 Smokehill Lane Woodstock, GA 30188
*SEE MANUFACTURER APPLICATION INSTRUCTIONS AND SPECIFICATIONS FOR SURFACE PREPARATION AND APPLICATION PROCESS	