

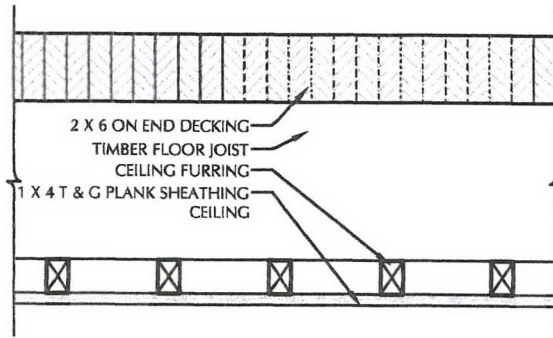

FC2

1 HOUR FIRE ASSEMBLY - WOOD FRAME FLOOR / CEILING

TYPICAL FLOOR/CEILING ASSEMBLY: DECKING 2" X 6" ON END / JOIST 2" X 14" TIMBERS
CEILING FURRING / CEILING 1" X 4" T&G PLANK SHEATHING



VIEW 1

TO ACHIEVE 1 HOUR FIRE RATING:

Apply 30 mil thickness (dry) of Forcefield® Fireguard® E-84 to exposed T&G ceiling.

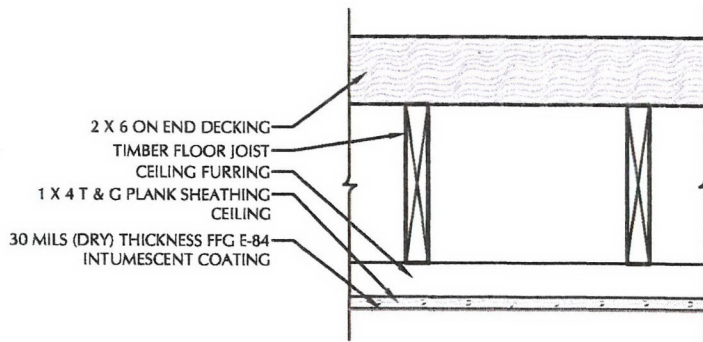

VIEW 2

SCALE: N.T.S.

FIRE TEST ENDURANCE RATING:	1 HOUR
STANDARD TESTED TO:	ASTM E-119
FIRE TESTED LABORATORY:	GUARDIAN FIRE TESTING LABORATORIES, INC. 480 HINMAN AVE. BUFFALO, NY 14216
REPORT NO:	GL 60911
PRODUCT:	ForceField® FireGuard® E-84 INTUMESCENT COATING (FFG E-84)
MANUFACTURER:	SHIELD INDUSTRIES, INC. 131 SMOKEHILL LANE WOODSTOCK, GA 30188



R. Joseph Beaman
11/27/13



Laura Ann Hinton 11/18/13

* SEE MANUFACTURER APPLICATION INSTRUCTIONS AND SPECIFICATIONS FOR SURFACE PREPARATION AND APPLICATION PROCESS